

### Product Features

- Piston type high pressure regulator
- Line and Panel mounting pressure regulator
- Brass chrome plated body and bonnet for non-corrosive gases and mixtures up to grade 6.0
- Stainless steel 316L body for corrosive gases
- 4 ports flexible configuration
- Simple outlet pressure limitation by handwheel
- Stable outlet pressure
- Inlet filter
- Tested for use with oxygen

### Typical Applications

- Component Testing
- Calibration Systems
- Laboratory Pressure Control
- High Pressure Sampling Systems
- Service & Test Equipment

### Dimensions (mm)

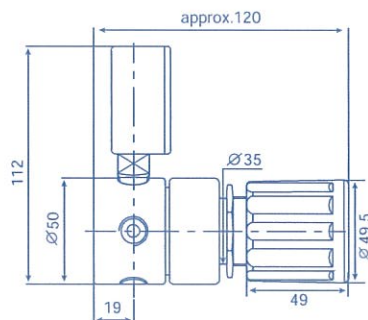

## VSR-6L & VSR-6P Series

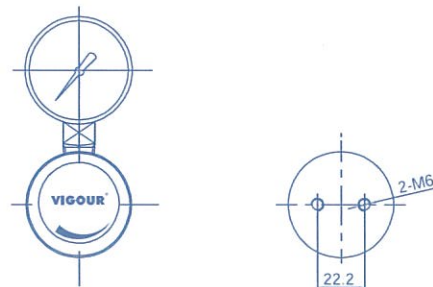
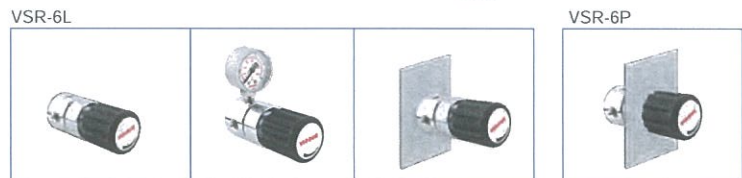

### Technical Data

Type:	single-stage
Inlet pressure P <sub>1</sub> :	max. 400bar
Outlet pressure P <sub>2</sub> :	50/100/200 bar
Materials	
Body regulator	see ordering info
Valve seat:	PCTFE
Piston:	SS316L
O-ring:	Viton® (FKM)
(option)	Kalrez® (FFKM)
Filter:	SS 316L
Inlets and Outlets:	1/4" NPT(F)
Temperature range:	-30°C to +74°C
Leak rate (to atmosphere)	1x10 <sup>-8</sup> mbar l/s He
(via seat)	1x10 <sup>-6</sup> mbar l/s He
Flow capacity:	Cv=0.06
Weight:	1.13 kg

### Flow Chart

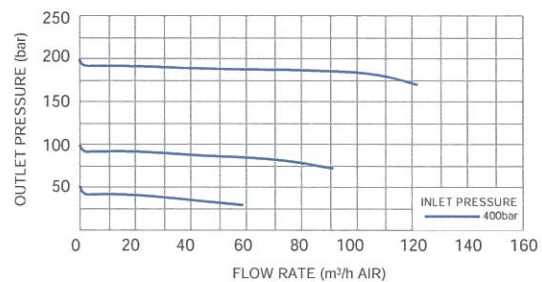

**Wir bieten Lösungen für Ihre Ideen!**  
**We offer solutions regarding your ideas!**

## Ordering Information

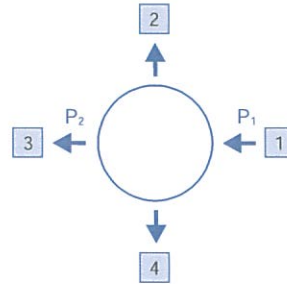

### Inlets / Outlets

00: 1/4" NPT(F)	10: 1/8" Tube fitting	16: 8mm Tube fitting	P: Gauge(Psig/bar) B: Plug
01: 1/4" NPT(M)	11: 1/4" Tube fitting	65: 6mm weld tube	
02: 3/8" NPT(F)	12: 3/8" Tube fitting	66: 8mm weld tube	
03: 3/8" NPT(M)	15: 6mm Tube fitting		

\* Other connection standard, consult factory.

### Port Selection

VSR - 6P S - 300 - 50 - 1 - 2 - 3 - 4 - N2

#### Type

L: Line  
P: Panel

#### Body Material

S: 316L  
C: Chrome Plated Brass  
B: Brass

#### Inlet Pressure P1

300: 300 bar  
400: 400 bar

#### Type Of Gas

Please specify type of gas

#### Outlet Pressure P2

50: to 50 bar  
100: to 100 bar  
200: to 200 bar

## Ordering Example

Example: VSR - 6L C - 300 - 50 - 00 - P - 00 - B - O2

1 - 2 - 3 - 4

